

Pos. Nr. Pos. no.	Beschreibung Description	Art.-Nr. Art. no.	Preisgruppe Price bracket
1	Motor Motor	85125	27
2	Kardanschale Cardan bearing	87104	4
3	Kardanschale 8,0 mm Cardan bearing 8,0mm	87152	3
4	Platine komplett Printed circuit assembly	87859	19
5	Lichtleitstäbesatz Light transmission bar set	107656	8
6	Lichtabdeckungssatz Light cover set	107657	6
7	Drahtlampe T3/4 16V 30mA Light bulb T3/4 16V 30mA	108616	8
8	GF-Schraube M2x5 mm GF-Screw M2x5	114966	3
9	Puffer flach Buffer flat	107658	5
10	Puffer gewölbt Buffer vaulted	107659	5
11	Decoder 6 pol. Decoder 6 pin.	10885	--
12	Gehäuse komplett Betr. Nr. 132 025-8 Body assembly No. 132 025-8	138560	32
13	Fenster satz Set of windows	107654	12
14	Führerstand-Trittbrettsatz Drivers cab and treadle set	107655	8

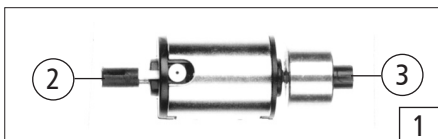

Änderungen in Konstruktion und Ausführung vorbehalten
We reserve the right to change the construction and specification

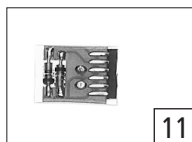
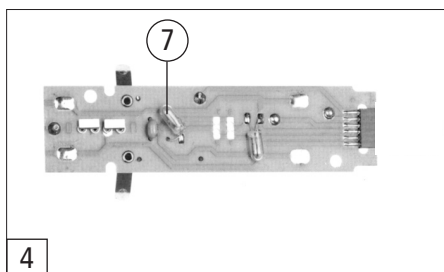
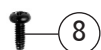
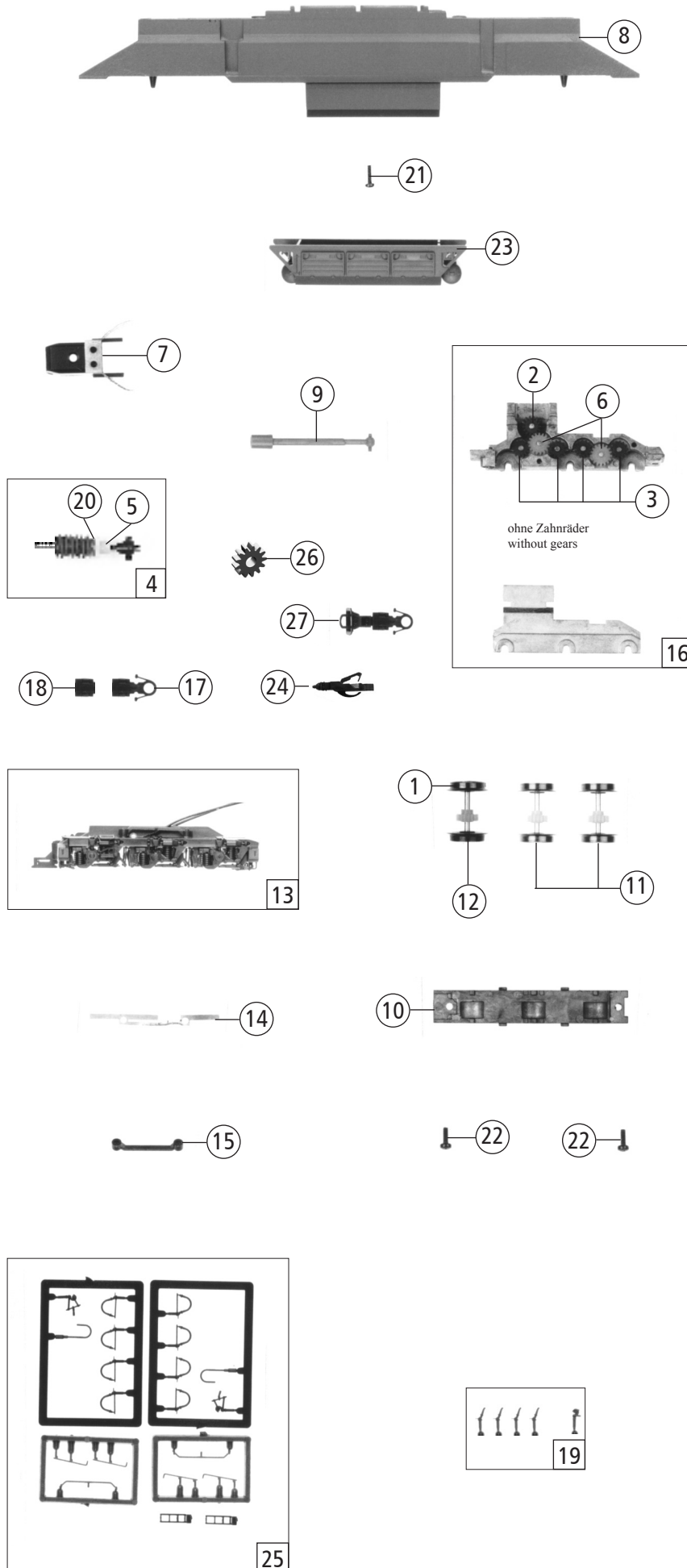

Pos. Nr. Pos. no.	Beschreibung Description	Art.-Nr. Art. no.	Preisgruppe Price bracket
1	Haftring N 8-10mm 0,3 Traction tyre set	85611	10
2	Schnecken Zahnrad Z=19/14 M=0,3 Gear wheel Z=19/14 M=0,3	86400	4
3	Zahnrad Z=14 gerade M=0,3 rot Gear wheel Z=14 M=0,3 red	86496	3
4	Schneckensatz Worm gear set	86979	13
5	Schneckenlager Worm gear axle bearing	89750	5
6	Zwischenzahnrad Z=17/M=0,3 Gear wheel between Z=17/M=0,3	97738	4
7	Schneckendeckel Worm gear cover	108051	7
8	Grundrahmen Basic frame	123538	17
9	Kardanwelle Cardan shaft	107646	4
10	Getriebeboden Gear bottom	107649	6
11	Radsatz ohne Haftring Wheelset without traction tyre	107650	10
12	Radsatz mit 2 Haftringen Wheelset with traction tyre	107651	11
13	Blende kpl. Bogie frame assembly	107652	13
14	Radkontakt Wheel contact	108045	4
15	Kontakthalter Contact holder	108046	3
16	Getriebebesatz ohne Zahnräder Gear part set without gears	108048	7
17	Kupplungskammer Coupling box	108090	3
18	Kupplungsdeckel Coupling cover	108091	3
19	Bremsschlauch und Kupplungshaken Brake hose and coupling hook	109329	3
20	Scheibe Disc	112394	4
21	Schraube M1,6x6 mm Screw M1,6x6	113069	3
22	GF-Schraube M1,6x4 mm GF-Screw M1,6x4	114850	3
23	Tank bedruckt Tank coated	107645	4
24	TT - Kupplung TT - Coupling	130090	6
25	Zurüstbeutel Bag with accessories	128120	10
26	Zahnrad Z=13 Gear wheel Z=13	86518	3
27	Kupplung kpl. Coupling complete	107653	5