

Pos. Nr. Pos. no.	Beschreibung Description	Art.-Nr. Art. no.	Preisgruppe Price bracket
1	Platine komplett m. LED Printed circuit assembly w. LED	126403	57
2	Puffer rund Buffer round	127008	3
3	Stingriff Handrail in front	127009	3
4	Brückenbaugruppe Connector	126404	12
5	Umlauf lackiert Running board coated	127039	5
6	TS-Führerstand -himmel .... Part set drivers cab	127029	10
7	GF-Schraube M1,6x4 GF-Screw M1,6x4	114850	2
8	TS-Deichsel, Maschineneinrichtung... Part set drawbar, machineinterior,....	127031	7
9	TS-Gehäuse lackiert Part set body coated	127040	19
10	Gehäuse kpl. Betr.nr. ST44 002 Body assembly Loco no. ST44 002	127036	66
11	TS-Fenster u. Lichtleiter Part set window a. light transmission bar	127037	17
12	Motor Motor	85144	55
13	Kardanschale Cardan bearing	87104	3
14	TS-Kardanschale u. Kardanwelle Part set cardan bearing a. cardan shaft	126402	10
15	Schneckensatz Worm set	86979	24
16	Schneckenachslager Bearing for worm axle	89750	4
17	Beilagscheibe Washer	120735	2
18	Lüftergitter Fan grill	127010	5

Änderungen in Konstruktion und Ausführung vorbehalten  
We reserve the right to change the construction and specification

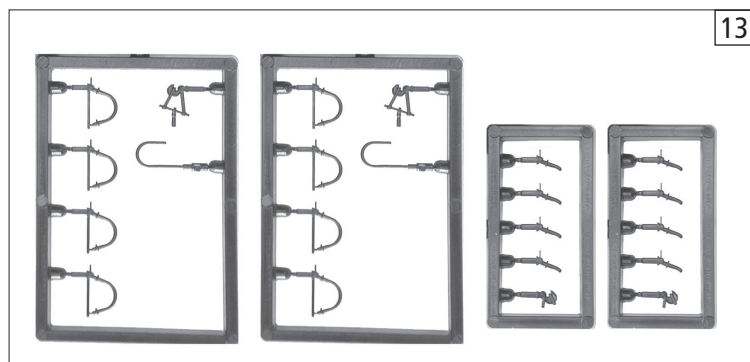
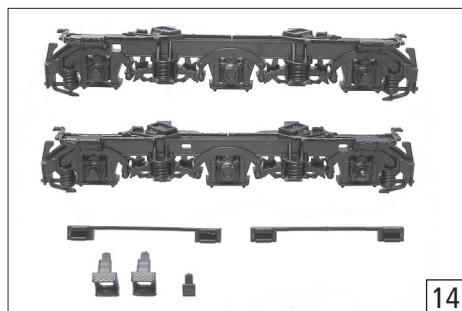
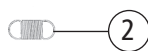
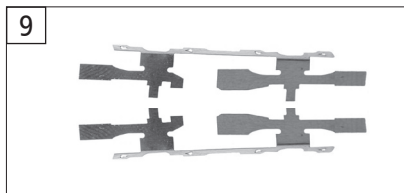
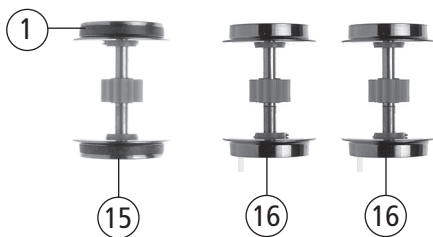
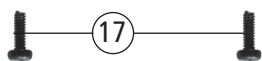
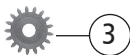
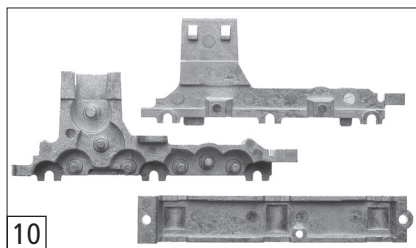
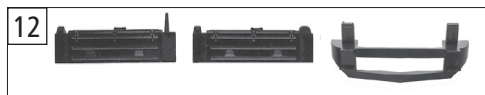
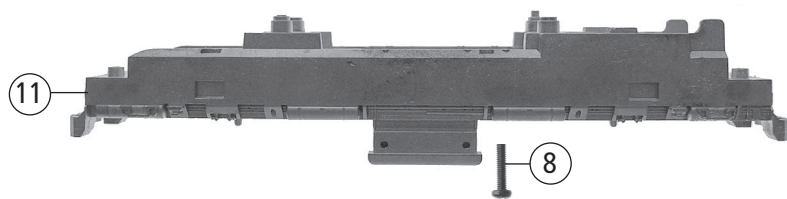

36234		PKP	ST44	=	
Pos. Nr. Pos. no.	Beschreibung Description	Art.-Nr. Art. no.	Preisgruppe Price bracket		
1	Haftrings.10Stk. 8-10mm 0,3 Set with traction tyres 10 pieces	85611	17		
2	Zugfeder Spring	86249	2		
3	Zwischenzahnrad Z=17 M=0,3 Between gear Z=17 M=0,3	97738	3		
4	Schnecken Zahnrad Z=22/12 M=0,3 Worm gear Z=22/12 M=0,3	86482	3		
5	TT-Kupplung neu Tilling TT-Coupling new Tilling	124371	19		
6	Zahnrad Z=14 M=0,3 Gear Z=14 M=0,3	86496	2		
7	Zahnrad Z=19 Gear Z=19	86499	2		
8	Schraube M1,6x6mm Screw M1,6x6mm	113069	2		
9	TS-Radkontakt li. u. re. Part set wheel current contact strip le. a. ri.	126416	7		
10	Teilesatz Getriebe Part set gear	127032	15		
11	Grundrahmen Main frame	127028	23		
12	Tankbehälter links, rechts a. Schienenräumer Tank box left, right a. Track sweeper	127030	10		
13	Zurüstbeutel Bag with accessories	126406	15		
14	TS-Blende links u. rechts Part set bogie frame left a. right	127035	24		
15	Radsatz mit 2 Haftringen Wheelset with 2 traction tyres	127034	20		
16	Radsatz ohne Haftringe Wheelset without traction tyres	127033	18		
17	GF-Schraube M1,6x4 GF-Screw M1,6x4	114850	2		